

R55

**R** YOU READY?

NOTHING LESS THAN A MILESTONE. BAVARIA **R55**



**BAVARIA**  
YACHTS

ENGINEERING

*your happiness*

# READY FOR A REVOLUTIONARY MASTERPIECE?

FOR SOMETHING TO BE CALLED A REVOLUTION, IT HAS TO BE REALLY SIGNIFICANT – TRULY MAGNIFICENT. GROUND-BREAKING. AN ABSOLUTE MILESTONE CONCEIVED OUT OF LOVE, BUILT WITH PASSION AND ULTIMATE ENGINEERING SKILL. PREPARE TO BE ENTHRALLED BY SOMETHING COMPLETELY NEW.

JUST SEE FOR YOURSELF: [WWW.BAVARIAYACHTS.COM/R55](http://WWW.BAVARIAYACHTS.COM/R55)







When we conceived the BAVARIA R55, we had one premise: we wanted people to feel at home on board this yacht. The same comfort, the same feeling of wellbeing. Carefully selected colours and top-grade materials produce exactly that effect. And it was important to us to create spaces that flow into one another and provide privacy – especially in the cabins themselves. We have created a wonderful space for socialising: the brightly illuminated saloon. It is, in a sense, a panoramic living room on the water. Welcome home. Welcome to the BAVARIA R55.

# R

## EVOLUTIONARY MASTERPIECE



There are many, many yachts in the world. We wanted the BAVARIA R55 to set a benchmark and be something incomparable. A yacht so good that it's respectful of her heritage, contemporary with the present, ready for the future.

The result: a pioneering, dynamic hull design without equal. Then there is the intentionally low-profile flybridge and deck lines – making the boat much sleeker and more elegant. All in all, the BAVARIA R55 turns heads and performs astonishingly. A true revolution, in other words. Are you ready?

### A REVOLUTION IN DETAIL

- 1 Wetbar
- 2 Helmstand
- 3 Seating area
- 4 Galley & aft cockpit
- 5 Skylounge
- 6 Helmstand
- 7 Master cabin
- 8 Guest cabin
- 9 Forward guest cabin

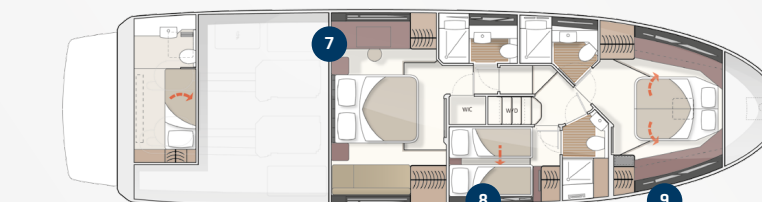
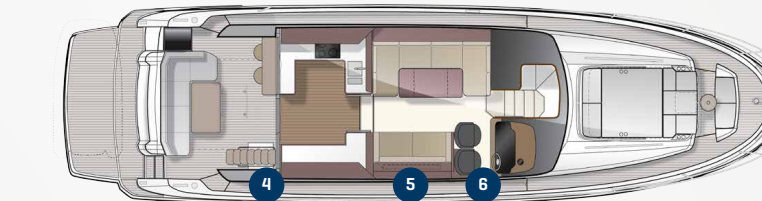
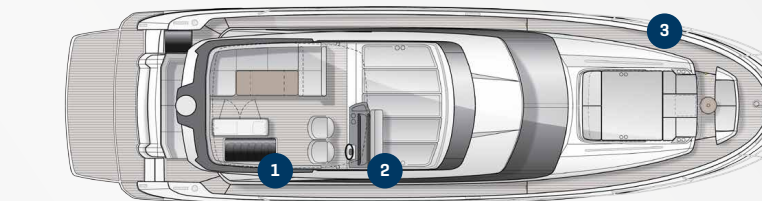

# TECHNICAL DATA OF THE BAVARIA R55

Length overall (incl. bathing platform)	17.69 m
Length hull	16.21 m
Beam overall	4.66 m
Height above waterline	4.39 m
Draught (incl. IPS Pods, approx.)	1.27 / 1.33 m
Unloaded weight from (approx.)	19 500 kg
Fuel tank	2 000 l
Water tank	600 l
People, max. CE Cat B	12 (tbc)
Cabins – Heads	3 – 3
Berths	6 + 1
Height in cabin (approx.)	1.98 m
Drivetrain & Engines: 2 x Volvo D8 IPS -800 [600 hp]*, zero sea state	30 knots
Drivetrain & Engines: 2 x Volvo D11 IPS -950 [723 hp]*, zero sea state	34 knots

\*50 % load, clean hull

## Bavaria Yachtbau GmbH

Bavariastraße 1

97232 Giebelstadt

Germany

Phone +49 9334 942-0

Fax +49 9334 942-1160

[www.bavariayachts.com](http://www.bavariayachts.com)

[info@bavariayachts.com](mailto:info@bavariayachts.com)

