

VIRTESS



ENGINEERING YOUR HAPPINESS.

BAVARIA VIRTESS LINE: VIRTESS 420 FLY | VIRTESS 420 COUPE



VIRTESS







VIRTESS 420

LUXURY, DESIGN AND SPEED

BAVARIA'S VIRTESS LINE

With classic lines and a contemporary design, the VIRTESS from BAVARIA YACHTS combines luxury, comfort and many smart details in one motor yacht. The owner's cabin has the dimensions of a suite, while the VIP and guest cabins are generously proportioned and fitted out for family and friends who want to share one thing only: that feeling of relaxed luxury aboard a VIRTESS.

The VIRTESS 420 FLY and the VIRTESS 420 COUPE are characterised by the utmost spaciousness and comfort.

Powerful, dynamic dual drives in either a Z-drive or IPS-drive and a sporty hull design make for an impressive sailing experience with a VIRTESS. The VIRTESS obeys every command from the helm at any speed and can be manoeuvred with absolute precision in the harbour. The VIRTESS is a motor yacht that offers pure sailing pleasure.



VIRTESS 420 FLY



VIRTESS 420 COUPE



STATE OF THE ART DESIGN

The VIRTESS line is built by the renowned naval architect design office and consultancy company INSENAVAL, while the top Italian designer Marco Casali's agency, TOO DESIGN, is the creator of its timeless interior and exterior design. Working together with the BAVARIA product managers and designers, they meticulously and systematically planned the VIRTESS line, from the first designs on the drawing board to implementing the drawings in CAD/CAM programs.

Seaworthiness and efficiency are non-negotiable qualities in a BAVARIA motor yacht; among other characteristics, a high-sided hull ensures that this demand is satisfied. With a VIRTESS you don't only sail safely, you also feel secure when moving around on board. This is due to broad gunwales and a railing that extends from bow to stern.

BAVARIA YACHTS is one of the world's most innovative shipyards, working with the best suppliers of engines – such as Volvo Penta – to equip our motor yachts with cost-effective and powerful engines. Besides the strong Z-drive, we also use Volvo Penta's modern IPS system, a Pod system with forward-facing double propellers, on the VIRTESS. The IPS-drive offers considerable advantages with regard to performance, exhaust emissions and comfort. It increases range by 40 per cent at a 20 per cent higher top speed, with 30 per cent less fuel consumption and thus also 30 percent less CO₂ emissions. With a joystick and software adapted to every individual BAVARIA, the two IPS-drives become the ultimate docking system in the harbour. Berthing with the fingertips – child's play!

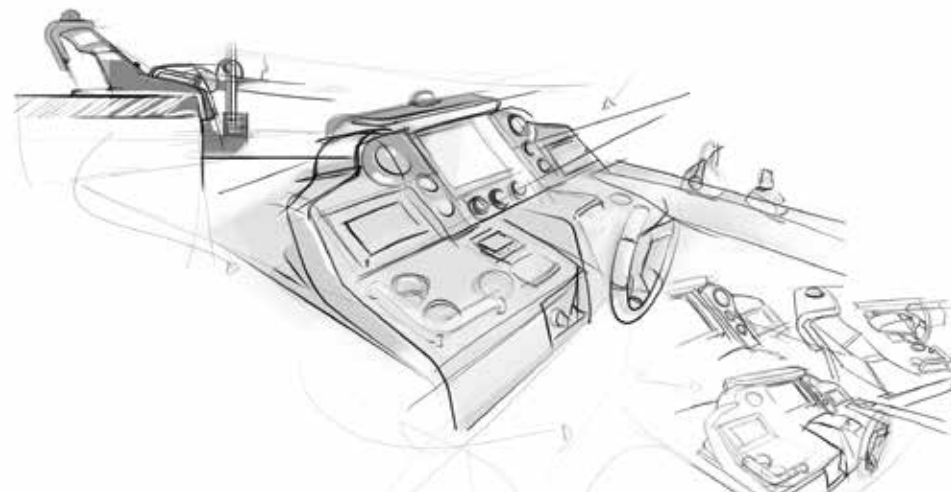
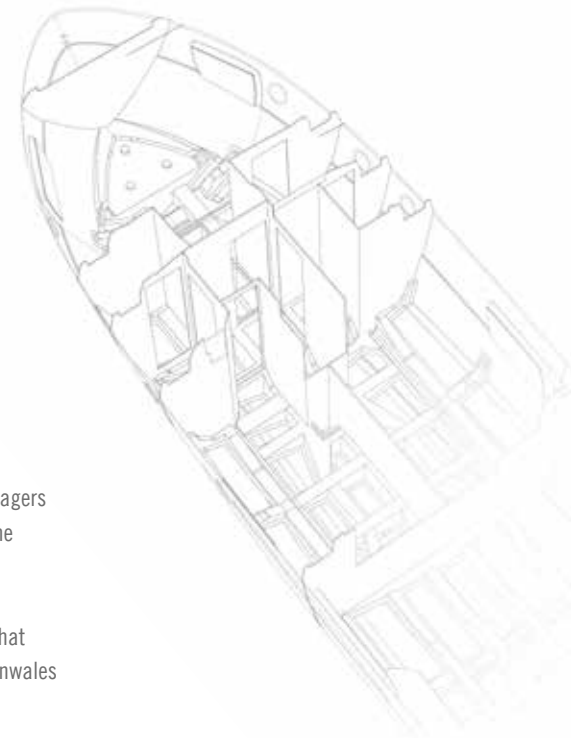



100% MADE IN GERMANY FOR 100% JOY

A BAVARIA yacht is the perfect interaction of many elements. Everything is built around the extensive expertise of German engineering. It is an art that looks back on a long and successful tradition in boat building. Today it is possible to implement all this knowledge with a high degree of precision and quality. We make use of the best materials, the best equipment and exquisite craftsmanship to create something that is the essence of every BAVARIA: the joy of yachting.

BAVARIA YACHTS consists of a 200,000 square metre shipyard with a 70,000 square metre production area that includes the lamination halls, a joinery shop, workshops and five assembly lines.



BAVARIA

THE SHIPYARD



MADE

IN GERMANY

A BAVARIA boat combines boat building tradition, German engineering and the ability to manufacture yachts precisely to the millimeter with the use of modern industrial production facilities. From bow to stern, every BAVARIA is a perfect combination of the highest quality, the best materials and the most innovative state-of-the-art fittings and equipment available in yacht building today. A BAVARIA is a yacht that has been created for living the perfect experience on the water, nothing less.



BAVARIA – GERMAN MADE YACHTS



All BAVARIA yachts are produced in their entirety in Germany at the Giebelstadt site – from the first laminate to the last buff and polish. This shipyard is one of the most modern and innovative production sites for yachts in the world. BAVARIA YACHTS was the first shipyard in the history of yacht building to use robots and modern CNC machines in production.



The entire interior of a BAVARIA, from the solid wood batten in each cabin to the entire galley, is produced in the company's own workshop by our experienced boat builders. Each wooden part of a BAVARIA receives up to six layers of varnish on its own varnish production line.



The hull and deck of a BAVARIA are made of sandwich construction with foam inserts. Where fittings are mounted, the deck is reinforced with aluminium sheets. Using modern transport systems, the deck and hull first go through a separate production process each before they are screwed and glued together.



FASCINATING FLYBRIDGE DYNAMIC PERFORMANCE COUPLED WITH LUXURY

The VIRTESS 420 FLY from BAVARIA YACHTS is the perfect combination of luxury and powerful drive dynamics, with quality features and functionality to boot. The VIRTESS 420 FLY has an impressively large flybridge with a driver's seat for two people. Next to it is a comfortable sun lounger, which can be folded down to create an additional passenger seat. A breath-taking sense of space below deck and stylish design above deck is what make the VIRTESS line such a unique motor yacht in the premium segment.

VIRTESS 420 FLY



BAVARIA
VIRTESS 420 FLY



LIVING SPACE

The owner should not adapt to the yacht – the yacht must meet the owner's demands under every conceivable situation. The VIRTESS 420 FLY does this and more. Thanks to an innovative track system, tables and benches in the cockpit can be moved around to accommodate any occasion. The flybridge is there to enjoy the performance of the VIRTESS 420 FLY on the water and to relax on the sun lounger or enjoy lunch at the table.







LIFE

BELOW DECK

Inside there is a spacious and light-filled saloon area with a generous seating area and an equally flexible and adjustable saloon table. With its own private bathroom, the owner's cabin is comparable with a suite and visitors will feel right at home in the two large guest cabins.

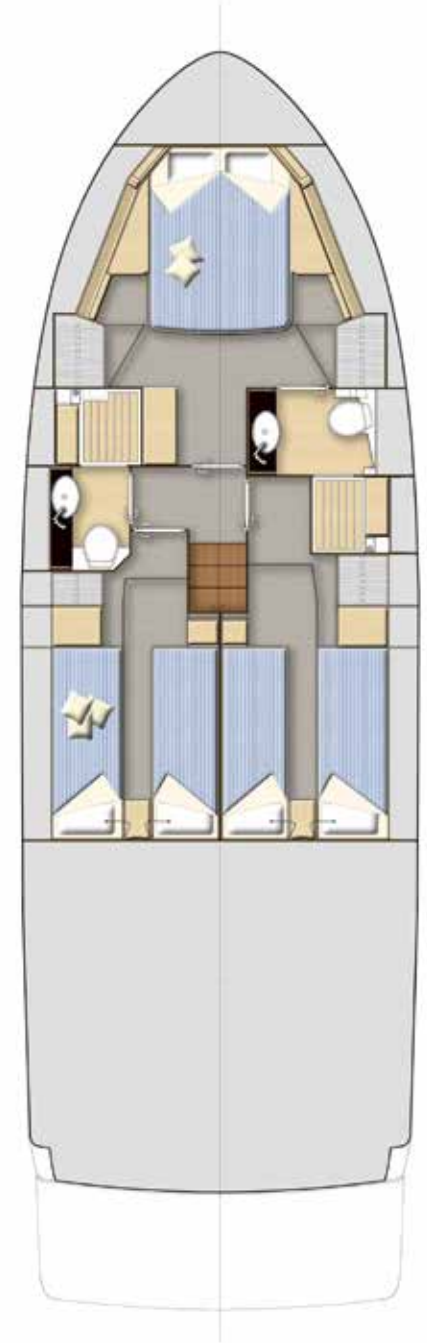

Lower Deck



TECHNICAL DATA
VIRTESS 420 FLY

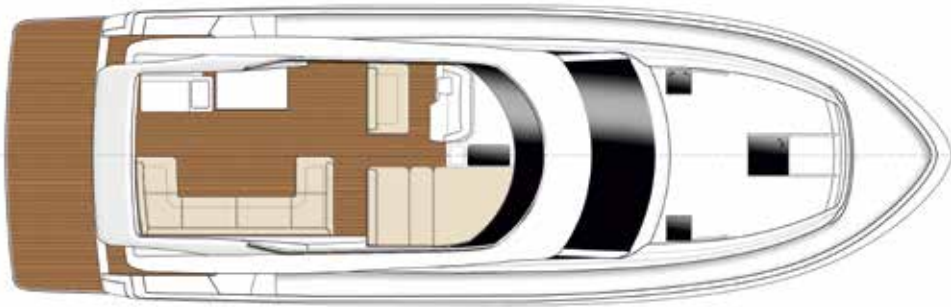

Fly deck



Deck

Length overall	12,39 m / 40' 8"	Water tank (approx.)	410 l / 108 gal
Length overall incl. Bathing Platform	13,60 m / 44' 7"	Cabins	3
Length hull	11,95 m / 39' 2"	Berths	6
Beam overall	4,21 m / 13' 10"	Height in cabin (approx.)	1,95 m / 6' 5"
Height above waterline	4,95 m / 16' 3"	Passengers (max CE B)	12
Draught, drive raised (approx.)	0,77 m / 2' 6"		
Draught, drive lowered	1,11 m / 3' 8"		
Unladen weight from (approx.)	11.400 kg / 25133 lbs		
Fuel tank (approx)	1.200 l / 317 gal		

All data are subject to change without notice and given without warranty.





THE EPITOME OF LUXURY, DESIGN AND PERFORMANCE

With its pure lines and an exceptionally modern design, the VIRTRESS 420 COUPE is nothing but seductive. She is the embodiment of state of the art technology and innovative solutions. The large COUPE roof can be opened at the press of a button, transforming the VIRTRESS 420 COUPE into a true convertible.

The helm was designed according to the most modern criteria to ensure a perfect overview of all the instruments and controls under all sailing conditions. There is space at the helm for two, because the pleasure of the luxury and comfort aboard a VIRTRESS 420 COUPE should really be shared.

VIRTESS 420 COUPÉ



BAVARIA

VIRTESS 420 COUPE

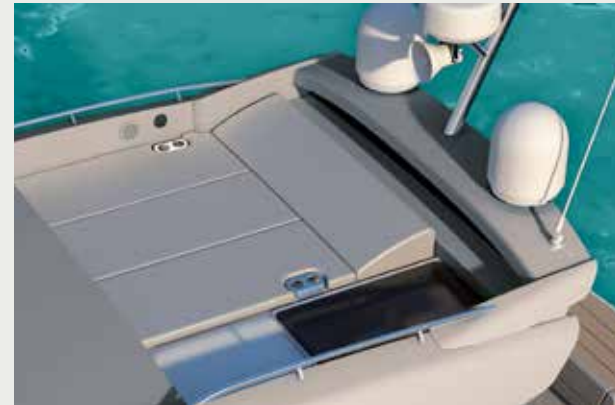

The VIRTESS 420 COUPE is of course a true COUPE motor yacht – yet the COUPE roof has a real saloon area where you can not only relax, but from where you can also for example control the music system – just one of many smart details on board the VIRTESS 420 COUPE. Or perhaps you would rather stretch out in the sun on the large (2 x 2 m) sun deck on the bow? The VIRTESS 420 COUPE – designed for luxurious hours at sea.



LIVING SPACE



LIFE

BELOW DECK

An ingenious lighting concept creates a uniquely pleasant touch of life in all the spaces on board the VIRTESS 420 COUPE. The large sliding door to the cockpit not only allows a perfect 360-degree view of the entire VIRTESS 420 COUPE, it also combines the cockpit and large salon to form one unit. Like the VIRTESS 420 FLY, the VIRTESS 420 COUPE has three cabins and a spacious saloon.



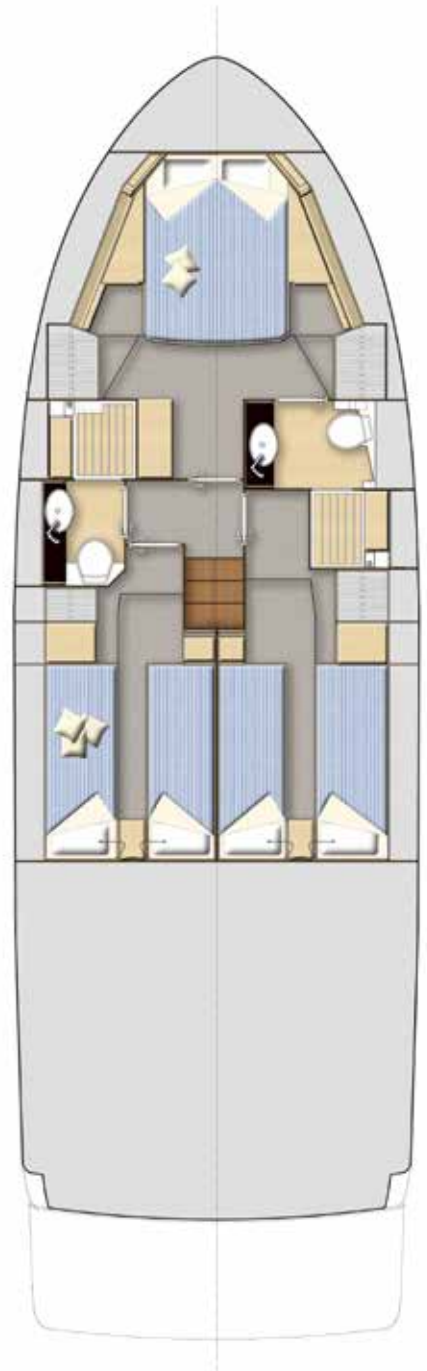

Lower Deck



Side view



Coupé-Deck

Length overall	12,39 m / 40' 8"
Length overall incl. Bathing Platform	13,60 m / 44' 7"
Length hull	11,95 m / 39' 2"
Beam overall	4,21 m / 13' 10"
Height above waterline	4,55 m / 14' 11"
Draught, drive raised (approx.)	0,77 m / 2' 6"
Draught, drive lowered	1,11 m / 3' 8"
Unlade weight from (approx.)	11.000 kg / 24251 lbs
Fuel tank (approx)	1.200 l / 317 gal

Water tank (approx.)	410 l / 108 gal
Cabins	3
Bathrooms	2
Berths	6
Height in cabin (approx.)	1,95 m / 6' 5"
Passengers (max CE B)	12

All data are subject to change without notice and given without warranty.





TECHNICAL DATA

VIRTESS 420 COUPE



VIRTESS 420



FEATURES

VIRTESS LINE

FIRST-RATE EQUIPMENT

Whether it is a short trip or a long journey, aboard the VIRTESS line you will have an unforgettable experience. The impressive amount of space with large storage room and many carefully designed details provide the ultimate in comfort. Enjoy maritime luxury of the latest generation.



The table and the separable bench in the stern can be effortlessly moved thanks to an innovative sliding system.



Access stairs to the lowerable bathing platform.



LED spotlight on foredeck and flydeck/coupe roof.



Intelligent details: pouf/dining chair with Lift&Flip function.



BAVARIA Yachtbau GmbH · Bavariastraße 1 · D-97232 Giebelstadt · Tel. + 49 9334 942 - 0 · Fax + 49 9334 942 - 1160

www.bavariayachts.com · info@bavaria-yachtbau.com

Some of the yachts shown here are equipped with optional extras which are available at an additional cost. Some details are based on design drawings and the final execution might differ.

This catalogue is not a part of a contract. All descriptions, photos, etc. are for illustration purposes only.